

# 586 Series Single Chip BASED LED

## T 3 1/4 MINIATURE BAYONET (BA9s)

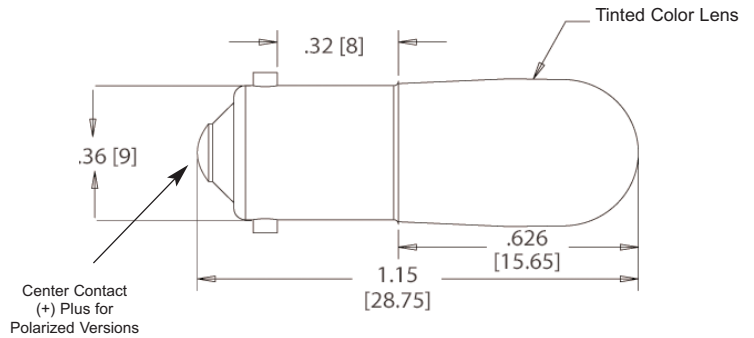

Measurements are typical  
Dimensions are inches [mm]

### T 3 1/4 MINIATURE BAYONET (BA9s) POLARIZED

PART NUMBER	COLOR	PEAK WAVELENGTH (nm)	VOLTAGE (VDC)	CURRENT TYP.-(mA)	INTENSITY TYP.-(mcd)	RoHS COMPLIANT
586-2401-101F	Red	630	6	15	1050	✓
586-2402-101F	Green	525	6	15	1650	✓
586-2403-101F	Yellow	592	6	15	1275	✓
586-2405-101F	Blue	470	6	15	487	✓
586-2406-101F	White	*	6	15	825	✓
586-2401-103F	Red	630	14	15	1050	✓
586-2402-103F	Green	525	14	15	1650	✓
586-2403-103F	Yellow	592	14	15	1275	✓
586-2405-103F	Blue	470	14	15	487	✓
586-2406-103F	White	*	14	15	825	✓
586-2401-105F	Red	630	28	15	1050	✓
586-2402-105F	Green	525	28	15	1650	✓
586-2403-105F	Yellow	592	28	15	1275	✓
586-2405-105F	Blue	470	28	15	487	✓
586-2406-105F	White	*	28	15	825	✓

### T 3 1/4 MINIATURE BAYONET (BA9s) NON-POLARIZED

PART NUMBER	COLOR	PEAK WAVELENGTH (nm)	VOLTAGE (VDC)	CURRENT TYP.-(mA)	INTENSITY TYP.-(mcd)	RoHS COMPLIANT
586-2401-201F	Red	630	6	15	1050	✓
586-2402-201F	Green	525	6	15	1650	✓
586-2403-201F	Yellow	592	6	15	1275	✓
586-2405-201F	Blue	470	6	15	487	✓
586-2406-201F	White	*	6	15	825	✓
586-2401-203F	Red	630	14	15	1050	✓
586-2402-203F	Green	525	14	15	1650	✓
586-2403-203F	Yellow	592	14	15	1275	✓
586-2405-203F	Blue	470	14	15	487	✓
586-2406-203F	White	*	14	15	825	✓
586-2401-205F	Red	630	28	7.5	525	✓
586-2402-205F	Green	525	28	7.5	825	✓
586-2403-205F	Yellow	592	28	7.5	637	✓
586-2405-205F	Blue	470	28	7.5	243	✓
586-2406-205F	White	*	28	7.5	412	✓

# Dialight

## 586 VIP Series

Variable Input 6-36 Volts DC

## Single Chip BASED LED

T 3 1/4 MINIATURE BAYONET BASE (BA9S)

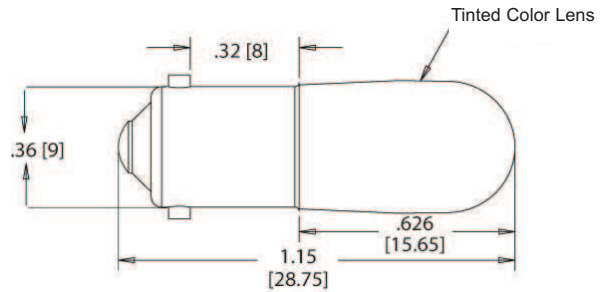

Measurements are typical  
Dimensions are inches [mm]

### T 3 1/4 MINIATURE BAYONET (BA9S) NON-POLARIZED MULTI-VOLTAGE INPUT

Part Number	Color	Dominant Wavelength (nm)	Nominal Voltage (VDC)	Forward Current TYP. (mA)	Intensity TYP. (mcd)	RoHS Compliant
586-2401-220F	Red	630	6-36	10	1000	✓
586-2402-220F	Green	525	6-36	10	1500	✓
586-2403-220F	Yellow	592	6-36	10	550	✓
586-2405-220F	Blue	470	6-36	10	200	✓
586-2406-220F	White	*	6-36	10	650	✓

\* Color Coordinates: x = 0.330, y = 0.365

# 586 Series - Sunlight Readable CLUSTER BASED LED T3 1/4 Miniature Bayonet (BA9s)

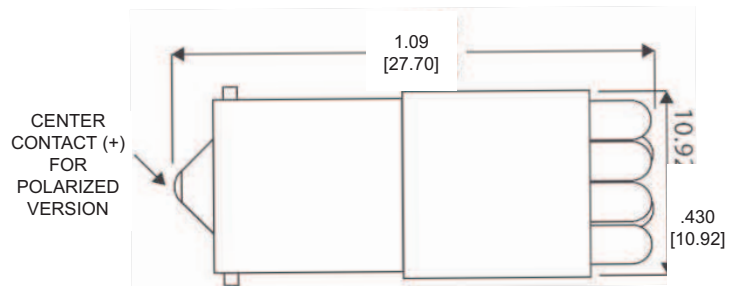

*Measurements are typical  
Dimensions are inches [mm]*

## POLARIZED

Part Number	Color	Peak Wavelength (nm)	Nominal Voltage (VDC)	Forward Current TYP.-(mA)	Intensity TYP.-(mcd)	RoHS Compliant
586-6401-101F	Red	630	6	100	1000	✓
586-6402-101F	Green	526	6	90	3800	✓
586-6403-101F	Yellow	592	6	100	2000	✓
586-6405-101F	Blue	472	6	90	850	✓
586-6406-101F	White	*	6	90	4800	✓
586-6401-103F	Red	630	14	50	1000	✓
586-6402-103F	Green	526	14	40	3100	✓
586-6403-103F	Yellow	592	14	50	2000	✓
586-6405-103F	Blue	472	14	40	685	✓
586-6406-103F	White	*	14	40	4800	✓
586-6401-105F	Red	630	28	17	1000	✓
586-6402-105F	Green	526	28	13	3600	✓
586-6403-105F	Yellow	592	28	17	2000	✓
586-6405-105F	Blue	472	28	13	780	✓
586-6406-105F	White	*	28	13	4200	✓

## NON-POLARIZED

Part Number	Color	Peak Wavelength (nm)	Nominal Voltage	Forward Current TYP.-(mA)	Intensity TYP.-(mcd)	RoHS Compliant
586-6401-201F	Red	630	6 VDC	100	1000	✓
586-6402-201F	Green	526	6 VDC	70	3400	✓
586-6403-201F	Yellow	592	6 VDC	100	2000	✓
586-6405-201F	Blue	472	6 VDC	70	685	✓
586-6406-201F	White	*	6 VDC	70	4000	✓
586-6401-203F	Red	630	14 VDC	50	1000	✓
586-6402-203F	Green	526	14 VDC	40	3400	✓
586-6403-203F	Yellow	592	14 VDC	50	2000	✓
586-6405-203F	Blue	472	14 VDC	40	685	✓
586-6406-203F	White	*	14 VDC	40	4000	✓
586-6401-205F	Red	630	28 VDC	18	1000	✓
586-6402-205F	Green	526	28 VDC	11	3400	✓
586-6403-205F	Yellow	592	28 VDC	18	2000	✓
586-6405-205F	Blue	472	28 VDC	11	685	✓
586-6406-205F	White	*	28 VDC	11	4000	✓
586-6401-206F	Red	630	120 VAC	9	500	✓
586-6402-206F	Green	526	120 VAC	9	2400	✓
586-6403-206F	Yellow	592	120 VAC	9	1000	✓
586-6405-206F	Blue	472	120 VAC	9	565	✓
586-6406-206F	White	*	120 VAC	9	3000	✓

# Dialight

## 585 Series

### CLUSTER BASED LED

### T3 1/4 Miniature Bayonet (BA9s)

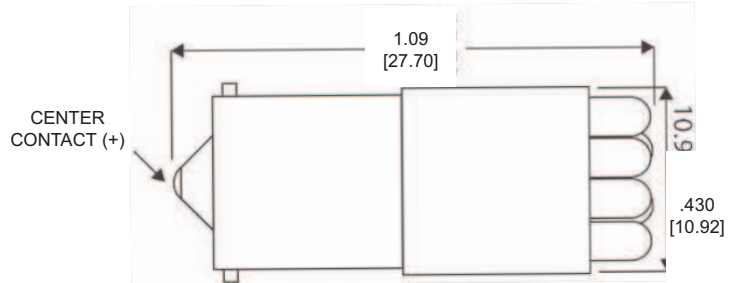

Measurements are typical  
Dimensions are inches [mm]

#### POLARIZED

Part Number	Color	Peak Wavelength (nm)	Nominal Voltage (VDC)	Forward Current TYP.-(mA)	Intensity TYP.-(mcd)
585-5211	Red	660	6	60	480
585-5311	Green	565	6	60	420
585-5511	Yellow	592	6	90	1800
585-5213	Red	660	14	40	480
585-5313	Green	565	14	40	420
585-5513	Yellow	592	14	60	1800
585-5215	Red	660	28	20	560
585-5315	Green	565	28	20	490
585-5515	Yellow	592	28	30	2100

#### NON-POLARIZED

Part Number	Color	Peak Wavelength (nm)	Nominal Voltage (VDC)	Forward Current TYP.-(mA)	Intensity TYP.-(mcd)
585-5223	Red	660	14	40	480
585-5323	Green	565	14	40	420
585-5523	Yellow	592	14	60	1800
585-5225	Red	660	28	20	560
585-5325	Green	565	28	20	490
585-5525	Yellow	592	28	30	2100
585-5256	Red	660	120 VAC	9	252
585-5356	Green	565	120 VAC	9	220
585-5556	Yellow	592	120 VAC	9	945

# Dialight

## 586 Series Single Chip BASED LED T3 1/4 MINIATURE SCREW (E10)

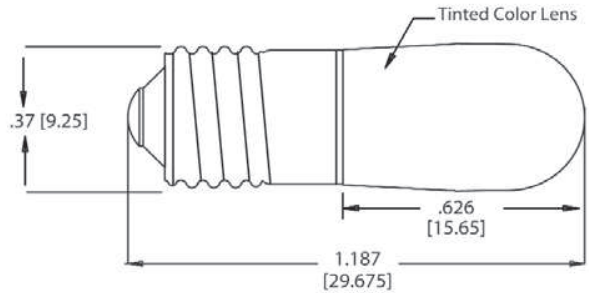

Measurements are typical

Dimensions are inches [mm]

### T3 1/4 MINIATURE SCREW (E10) NON-POLARIZED

PART NUMBER	COLOR	PEAK WAVELENGTH (nm)	VOLTAGE (VDC)	CURRENT TYP.-(mA)	INTENSITY TYP.-(mcd)	RoHS COMPLIANT
586-2701-201F	Red	630	6	15	1050	✓
586-2702-201F	Green	525	6	15	1650	✓
586-2703-201F	Yellow	592	6	15	1275	✓
586-2705-201F	Blue	470	6	15	487	✓
586-2706-201F	White	*	6	15	825	✓
586-2701-203F	Red	630	14	15	1050	✓
586-2702-203F	Green	525	14	15	1650	✓
586-2703-203F	Yellow	592	14	15	1275	✓
586-2705-203F	Blue	470	14	15	487	✓
586-2706-203F	White	*	14	15	825	✓
586-2701-205F	Red	630	28	7.5	525	✓
586-2702-205F	Green	525	28	7.5	825	✓
586-2703-205F	Yellow	592	28	7.5	637	✓
586-2705-205F	Blue	470	28	7.5	243	✓
586-2706-205F	White	*	28	7.5	412	✓

# Dialight

## 586 VIP Series

Variable Input 6-36 Volts DC

## Single Chip BASED LED

T 3 1/4 MINIATURE SCREW BASE (E10)

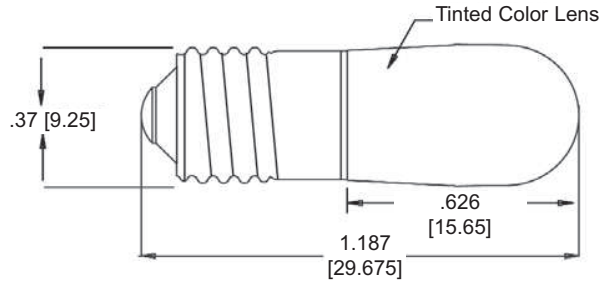

Measurements are typical  
Dimensions are inches [mm]

### T3 1/4 MINIATURE SCREW (E10) NON-POLARIZED MULTI-VOLTAGE INPUT

Part Number	Color	Dominant Wavelength (nm)	Nominal Voltage (VDC)	Forward Current TYP. (mA)	Intensity TYP. (mcd)	RoHS Compliant
586-2701-220F	Red	630	6-36	10	1000	✓
586-2702-220F	Green	525	6-36	10	1500	✓
586-2703-220F	Yellow	592	6-36	10	550	✓
586-2705-220F	Blue	470	6-36	10	200	✓
586-2706-220F	White	*	6-36	10	650	✓

\* Color Coordinates: x = 0.330, y = 0.365

# Dialight

## 586 Series BASED LED T3 1/4 WEDGE (T10)

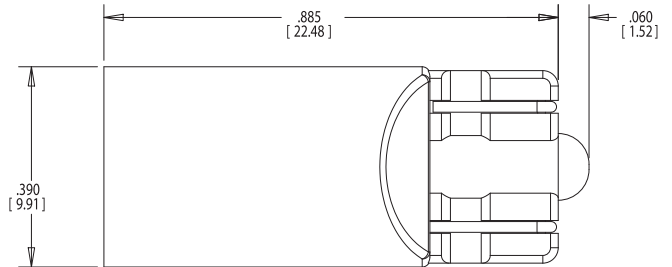

Measurements are typical  
Dimensions are inches [mm]

### T3 1/4 WEDGE NON-POLARIZED

PART NUMBER	COLOR	PEAK WAVELENGTH (nm)	VOLTAGE (VDC)	CURRENT TYP.-(mA)	INTENSITY TYP.-(mcd)	RoHS COMPLIANT
586-2201-201F	Red	615	6	69	770	✓
586-2202-201F	Green	528	6	30	300	✓
586-2203-201F	Yellow	591	6	69	550	✓
586-2205-201F	Blue	470	6	30	90	✓
586-2206-201F	White	*	6	30	630	✓
586-2201-202F	Red	615	12	37	820	✓
586-2202-202F	Green	528	12	19	380	✓
586-2203-202F	Yellow	591	12	37	590	✓
586-2205-202F	Blue	470	12	19	115	✓
586-2206-202F	White	*	12	19	800	✓
586-220A-202F	White/Yellow	* / 591	12	25	725	✓
586-220B-202F	White/Orange	* / 610	12	25	775	✓
586-2201-203F	Red	615	14	41	910	✓
586-2202-203F	Green	528	14	24	480	✓
586-2203-203F	Yellow	591	14	41	650	✓
586-2205-203F	Blue	470	14	24	145	✓
586-2206-203F	White	*	14	24	1000	✓
586-220A-203F	White/Yellow	* / 591	14	25	725	✓
586-220B-203F	White/Orange	* / 610	14	25	775	✓
586-2201-204F	Red	615	24	19	850	✓
586-2202-204F	Green	528	24	12	480	✓
586-2203-204F	Yellow	591	24	19	610	✓
586-2205-204F	Blue	470	24	12	145	✓
586-2206-204F	White	*	24	12	1000	✓
586-220A-204F	White/Yellow	* / 591	24	14	810	✓
586-220B-204F	White/Orange	* / 610	24	14	870	✓

\* White Color Coordinates: x = .320, y = .310